

(Part A) Application for an existing club certificate to be converted to a club premises certificate under the Licensing Act 2003 and (Part B) application to vary the club premises certificate simultaneously

PLEASE READ THE FOLLOWING INSTRUCTIONS FIRST

Before completing this form please read the guidance notes at the end of the form. If you are completing this form by hand please write legibly in block capitals. In all cases ensure that your answers are inside the boxes and written in black ink. Use additional sheets if necessary. You may wish to keep a copy of the completed form for your records.

W Bramshaw Golf Club
e

.....
[insert name of club]

apply to convert an existing club certificate to a club premises certificate under Schedule 8 to the Licensing Act 2003 for the club premises described in Part A1 below

Part A1 – Premises Details

Postal address of club premises or, if none, ordnance survey map reference or description The Club House Brook			
Post town	Lyndhurst	Post Code	SO43 7HE

Name of person performing duties of a secretary to the club Ian Baker			
Address of person performing duties of a secretary to the club Old Roundhill Brook			
Post town	Lyndhurst	Post code	SO43 7HG
Daytime contact telephone number (if any)	023 8081 3433		
E-mail address (optional)	golf@bramshaw.co.uk		

Telephone number of premises (if any)	023 8081 3433
Non-domestic rateable value of club premises	£51000

Part A2 – Club Operating Schedule

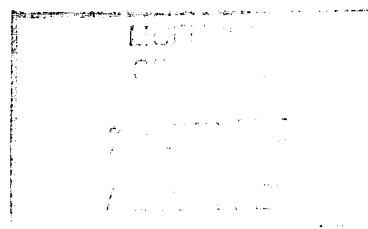

General description of club premises (please read guidance note 1)

The Clubhouse is situated 50 yards off the B3078 at Brook. It is a 2-storey building with the main entrance/exit at the rear of the building (i.e. furthest side from the road), comprising changing rooms, shower rooms, toilets and Club Office on the ground floor, and bar, restaurant, kitchen and toilets on the 1st floor. It has a small 1st floor balcony at the rear of the building overlooking the golf course (i.e. furthest side from the road) with emergency escape staircase to ground level.

The premises are of modern (steel frame, brick/tile) construction, built in 1984. It has a members/visitors car park with space for 145 vehicles.

Where 5,000 or more people attend the club premises at the same time, please state the number 0

What existing qualifying club activities are authorised by your existing club certificate(s)?

Provision of entertainment

Please tick Yes

- | | |
|---|--------------------------|
| a) plays | <input type="checkbox"/> |
| b) films | <input type="checkbox"/> |
| c) indoor sporting events | <input type="checkbox"/> |
| d) boxing or wrestling entertainment | <input type="checkbox"/> |
| e) live music | <input type="checkbox"/> |
| f) recorded music | <input type="checkbox"/> |
| g) a performance of dance | <input type="checkbox"/> |
| h) anything of a similar description to that falling within (e), (f) or (g) | <input type="checkbox"/> |

Provision of entertainment facilities for:

- | | |
|---|--------------------------|
| i) making music | <input type="checkbox"/> |
| j) dancing | <input type="checkbox"/> |
| k) entertainment of a similar description to that falling within (i) or (j) | <input type="checkbox"/> |

Supply of alcohol for members and guests

- | | |
|-------------------------------------|-------------------------------------|
| a) for consumption on the premises | <input checked="" type="checkbox"/> |
| b) for consumption off the premises | <input type="checkbox"/> |

State any limitations on the hours during which you are permitted by your certificate(s) or any additional authorisations to conduct club qualifying activities, including the supply of alcohol.

Premises occupied and habitually used for the purposes of the Club:-
Weekday from 0800 to 2300 hours
Sundays, Christmas Day and Good Friday from 0800 to 2200 hours

Permitted hours for the supply of intoxicating liquor
Weekday from 1100 to 2300 hours
Sundays, Christmas Day and Good Friday from 1200 to 1400 hours and 1700 to 2030 hours

Describe the conditions subject to which your existing certificate(s) has/have been granted (please read guidance note 2):

a) General – all four licensing objectives (b,c,d,e)

The primary purpose of the Club is to provide the facility to play golf to members, visitors and guests. Members are allowed to bring guests into the Club premises and guests are entitled to purchase liquor for consumption on the premises. Records of guests and visitors are kept by the Club. The Club does not open for the supply of intoxicating liquor on Christmas Day.

b) The prevention of crime and disorder

None

c) Public safety

None

d) The prevention of public nuisance

None

e) The protection of children from harm

Persons under 18 years of age are permitted entry to the Club and its premises but they are not permitted to purchase or consume intoxicating liquor or play the gaming machine.

Please tick Yes

- I have made or enclosed payment of the fee
- I have enclosed the existing certificate(s) or a certified copy of each certificate
- I have enclosed a plan of the club premises
- I have enclosed a copy of the club rules
- I have sent copies of this application to the chief officer of police (please read guidance note 3)
- I understand that if I do not comply with the above requirements my application will be rejected

IT IS AN OFFENCE, LIABLE ON CONVICTION TO A FINE UP TO LEVEL 5 ON THE STANDARD SCALE, UNDER SECTION 158 OF THE LICENSING ACT 2003 TO MAKE A FALSE STATEMENT IN OR IN CONNECTION WITH THIS APPLICATION

Part A3 – Signatures (please read guidance note 4)

Signature for and on behalf of

Bramshaw Golf Club

[insert name of club]. (Please read guidance note 5)

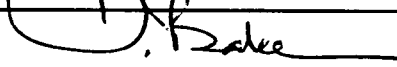
Signature	
Date	22/6/15
Capacity	General Manager

Contact name (where not previously given) and address for correspondence associated with this application (please read guidance note 16)

Post town		Post code	
------------------	--	------------------	--

IF YOU WISH TO APPLY SIMULTANEOUSLY FOR A VARIATION OF THE CLUB PREMISES CERTIFICATE IF IT IS CONVERTED FROM YOUR EXISTING CLUB CERTIFICATE(S) UNDER SECTION 84 OF THE LICENSING ACT 2003, NOW COMPLETE PART B OF THIS FORM.

IF YOU DO NOT WISH TO APPLY SIMULTANEOUSLY FOR A VARIATION OF THE CLUB PREMISES CERTIFICATE IF IT IS CONVERTED FROM YOUR EXISTING CLUB CERTIFICATE(S), YOU SHOULD LEAVE PART B BLANK.

PART B - Application to vary a club premises certificate under the Licensing Act 2003

Bramshaw Golf Club

[insert name of club]

being the proposed club premises certificate holder of an existing club certificate to be converted under the terms of Schedule 8 to the Licensing Act 2003 apply to vary it under section 84 of the Licensing Act 2003 for the premises described in Part A above.

Part B1 - Variation

Do you want the proposed variation to have effect from the second appointed day? Please tick

Day
Month
Year

If not when do you want the variation to take effect from

Please describe briefly the nature of the proposed variation (please read guidance note 1)
To include the new licensable activities of entertainment provision of films, indoor sporting events, live music and recorded music.
To include the new licensable activities for the provision of entertainment facilities for making music and dancing.
To vary the existing clubhouse opening hours.
To vary the existing licensing hours for the supply of intoxicating liquor.

If your proposed variation would mean that 5,000 or more people are expected to attend the club premises at the same time, please state the number expected to attend 0

Part B2 – Club Operating Schedule

Please complete those parts of the club operating schedule which would be subject to change if this application to vary were successful.

What club qualifying activities do you now intend to conduct on the club premises and/or at what varied times do you intend to conduct them ?

(please see section 1 of the Licensing Act 2003 and Schedule 1 to the Licensing Act 2003)

Provision of regulated entertainment

Please tick Yes

- | | |
|---|-------------------------------------|
| a) plays (if ticking yes, fill in box A) | <input type="checkbox"/> |
| b) films (if ticking yes, fill in box B) | <input checked="" type="checkbox"/> |
| c) indoor sporting events (if ticking yes, fill in box C) | <input checked="" type="checkbox"/> |
| d) boxing or wrestling entertainment (if ticking yes, fill in box D) | <input type="checkbox"/> |
| e) live music (if ticking yes, fill in box E) | <input checked="" type="checkbox"/> |
| f) recorded music (if ticking yes, fill in box F) | <input checked="" type="checkbox"/> |
| g) performances of dance (if ticking yes, fill in box G) | <input type="checkbox"/> |
| h) anything of a similar description to that falling within (e), (f) or (g) (if ticking yes, fill in box H) | <input type="checkbox"/> |

Provision of entertainment facilities:

- | | |
|---|-------------------------------------|
| i) making music (if ticking yes, fill in box I) | <input checked="" type="checkbox"/> |
| j) dancing (if ticking yes, fill in box J) | <input checked="" type="checkbox"/> |
| k) entertainment of a similar description to that falling within (i) or (j) (if ticking yes, fill in box K) | <input type="checkbox"/> |

Supply of alcohol (if ticking yes, fill in box L)

- | | |
|--|-------------------------------------|
| a) the supply of alcohol by or on behalf of a club to, or to the order of, a member of the club | <input checked="" type="checkbox"/> |
| b) the sale by retail of alcohol by or on behalf of a club to a guest of a member of the club for consumption on the premises where the sale takes place | <input checked="" type="checkbox"/> |

IN ALL CASES PLEASE COMPLETE BOXES M, N AND O

A

Plays Standard days and timings (please read guidance note 6)			Will the performance of a play take place indoors or outdoors or both – please tick (please read guidance note 7)	Indoors	<input type="checkbox"/>
				Outdoors	<input type="checkbox"/>
				Both	<input type="checkbox"/>
Day	Start	Finish	<u>Please give further details here</u> (please read guidance note 8)		
Mon					
Tue			<u>State any seasonal variations for performing plays</u> (please read guidance note 9)		
Wed					
Thu			<u>Non standard timings. Where you intend to use the premises for the performance of plays at different times to those listed in the column on the left, please list</u> (please read guidance note 10)		
Fri					
Sat					
Sun					

B

Films Standard days and timings (please read guidance note 6)			Will the exhibition of films take place indoors or outdoors or both – please tick (please read guidance note 7)	Indoors	<input checked="" type="checkbox"/>			
				Outdoors	<input type="checkbox"/>			
				Both	<input type="checkbox"/>			
Day	Start	Finish	<u>Please give further details here</u> (please read guidance note 8) Race night films with sound via speakers within the Clubhouse.					
Mon								
Tue								
Wed						<u>State any seasonal variations for the exhibition of films</u> (please read guidance note 9) None		
Thu								
Fri								
Sat						<u>Non standard timings. Where you intend to use the premises for the exhibition of films at different times to those listed in the column on the left, please list</u> (please read guidance note 10) Maximum of two such events to take place each year and be between 1900 hours and 2300 hours		
Sun								

C

Indoor sporting events Standard days and timings (please read guidance note 6)			<u>Please give further details here</u> (please read guidance note 8) Only type of event will be indoor skittles.
Day	Start	Finish	
Mon			<u>State any seasonal variations for indoor sporting events</u> (please read guidance note 9) None
Tue			
Wed			
Thu			<u>Non standard timings. Where you intend to use the premises for indoor sporting events at different times to those listed in the column on the left, please list</u> (please read guidance note 10) Maximum of three such events in each year, taking place indoors between 1200 hours and 2300 hours.
Fri			
Sat			
Sun			

D

Boxing or wrestling entertainment Standard days and timings (please read guidance note 6)			Will the boxing or wrestling entertainment take place indoors or outdoors or both – please tick (please read guidance note 7)	Indoors	<input type="checkbox"/>
				Outdoors	<input type="checkbox"/>
				Both	<input type="checkbox"/>
Day	Start	Finish	<u>Please give further details here</u> (please read guidance note 8)		
Mon					
Tue			<u>State any seasonal variations for boxing or wrestling entertainment</u> (please read guidance note 9)		
Wed					
Thu			<u>Non standard timings. Where you intend to use the premises for boxing or wrestling entertainment at different times to those listed in the column on the left, please list</u> (please read guidance note 10)		
Fri					
Sat					
Sun					

E

Live music Standard days and timings (please read guidance note 6)			Will the performance of live music take place indoors or outdoors or both – please tick (please read guidance note 7)	Indoors	<input checked="" type="checkbox"/>
				Outdoors	<input type="checkbox"/>
				Both	<input type="checkbox"/>
Day	Start	Finish			
Mon			Please give further details here (please read guidance note 8) Individual or groups of artistes booked to play live music at members' social events in the bar and restaurant areas of the Clubhouse. Music will be amplified or unamplified.		
Tue					
Wed			State any seasonal variations for the performance of live music (please read guidance note 9) None		
Thu					
Fri			Non standard timings. Where you intend to use the premises for the performance of live music at different times to those listed in the column on the left, please list (please read guidance note 10) We have no regular events of this nature but a maximum of five such events will take place each year and be between 1900 hours and 0100 hours.		
Sat					
Sun					

F

Recorded music Standard days and timings (please read guidance note 6)			Will the playing of recorded music take place indoors or outdoors or both – please tick (please read guidance note 7)	Indoors	<input checked="" type="checkbox"/>
				Outdoors	<input type="checkbox"/>
				Both	<input type="checkbox"/>
Day	Start	Finish	Please give further details here (please read guidance note 8) Occasional playing of recorded music will take place at members' social events such as dinner-dances (disco), and be amplified.		
Mon					
Tue			State any seasonal variations for playing recorded music (please read guidance note 9) None		
Wed					
Thu			Non standard timings. Where you intend to use the premises for the playing of recorded music at different times to those listed in the column on the left, please list (please read guidance note 10) We have no regular members' social events but a maximum of 15 ad-hoc events will take place per year between 1900 hours and 0100 hours.		
Fri					
Sat					
Sun					

G

Performance of dance Standard days and timings (please read guidance note 6)			Will the performance of dance take place indoors or outdoors or both – please tick (please read guidance note 7)	Indoors	<input type="checkbox"/>
				Outdoors	<input type="checkbox"/>
				Both	<input type="checkbox"/>
Day	Start	Finish	Please give further details here (please read guidance note 8)		
Mon					
Tue					
Wed			State any seasonal variations for the performance of dance (please read guidance note 9)		
Thu					
Fri					
Sat			Non standard timings. Where you intend to use the premises for the performance of dance entertainment at different times to those listed in the column on the left, please list (please read guidance note 10)		
Sun					

H

Anything of a similar description to that falling within (e), (f) or (g) Standard days and timings (please read guidance note 6)			<u>Please give a description of the type of entertainment you will be providing</u>		
Day	Start	Finish	Will this entertainment take place indoors or outdoors or both – please tick (please read guidance note 7)	Indoors	<input type="checkbox"/>
Mon				Outdoors	<input type="checkbox"/>
				Both	<input type="checkbox"/>
Tue			<u>Please give further details here</u> (please read guidance note 8)		
Wed					
Thu			<u>State any seasonal variations for entertainment of a similar description to that falling within (e), (f) or (g)</u> (please read guidance note 9)		
Fri					
Sat			<u>Non standard timings. Where you intend to use the premises for the entertainment of similar description to that falling within (e), (f) or (g) at different times to those listed in the column on the left, please list</u> (please read guidance note 10)		
Sun					

I

Provision of facilities for making music Standard days and timings (please read guidance note 6)			<u>Please give a description of the facilities for making music you will be providing</u> We will allow approved third parties to perform music in the bar and restaurant area of the Clubhouse at members' social events explained in boxes E and F of this application.							
			Will facilities for making music be indoors or outdoors or both – please tick (please read guidance note 7)	<table border="1"> <tr> <td>Indoors</td> <td><input checked="" type="checkbox"/></td> </tr> <tr> <td>Outdoors</td> <td><input type="checkbox"/></td> </tr> <tr> <td>Both</td> <td><input type="checkbox"/></td> </tr> </table>	Indoors	<input checked="" type="checkbox"/>	Outdoors	<input type="checkbox"/>	Both	<input type="checkbox"/>
Indoors	<input checked="" type="checkbox"/>									
Outdoors	<input type="checkbox"/>									
Both	<input type="checkbox"/>									
Day	Start	Finish								
Mon			<u>Please give further details here</u> (please read guidance note 8) Individual or groups of artistes booked to play live music at members' social events in the bar and restaurant areas of the Clubhouse. The music may be amplified or unamplified.							
Tue										
Wed			<u>State any seasonal variations for the provision of facilities for making music</u> (please read guidance note 9) None							
Thu										
Fri			<u>Non standard timings. Where you intend to use the premises for provision of facilities for making music entertainment at different times to those listed in the column on the left, please list</u> (please read guidance note 10) We have no regular members' social events but a maximum of 5 such events will take place each year and be between 1900 hours and 0100 hours.							
Sat										
Sun										

J

Provision of facilities for dancing Standard days and timings (please read guidance note 6)			Will the facilities for dancing be indoors or outdoors or both – please tick (please read guidance note 7)	Indoors	<input checked="" type="checkbox"/>
				Outdoors	<input type="checkbox"/>
				Both	<input type="checkbox"/>
Day	Start	Finish			
Mon			Please give further details here (please read guidance note 8) This will be restricted to members and guests dancing at social events mentioned in boxes E & F of this application. Dancing will be to either recorded or live music as detailed in boxes E & F of this application.		
Tue					
Wed			State any seasonal variations for providing dancing facilities (please read guidance note 9) None		
Thu					
Fri			Non standard timings. Where you intend to use the premises for the provision of facilities for dancing entertainment at different times to those listed in the column on the left, please list (please read guidance note 10) We have no regular members' social events but a maximum of 20 such events will take place each year and be between 1900 hours and 0100 hours (i.e 5 to live music and 15 to recorded music).		
Sat					
Sun					

K

Provision of facilities for entertainment of a similar description to that falling within i or j Standard days and timings (please read guidance note 6)			<u>Please give a description of the type of entertainment facility you will be providing</u>		
Day	Start	Finish	Will the entertainment facility be indoors or outdoors or both – please tick (please read guidance note 7)	Indoors	<input type="checkbox"/>
Mon				Outdoors	<input type="checkbox"/>
				Both	<input type="checkbox"/>
Tue			<u>Please give further details here</u> (please read guidance note 8)		
Wed					
Thu					
Fri			<u>State any seasonal variations for the provision of facilities for entertainment of a similar description to that falling within i or j</u> (please read guidance note 9)		
Sat					
Sun					
			<u>Non standard timings. Where you intend to use the premises for the provision of facilities for entertainment of a similar description to that falling within i or j at different times to those listed in the column on the left, please list</u> (please read guidance note 10)		

L

Supply of alcohol Standard days and timings (please read guidance note 6)			Will the supply of alcohol be for consumption (please tick box please read guidance note 11)	On the premises	<input checked="" type="checkbox"/>
				Off the premises	<input type="checkbox"/>
Day	Start	Finish		Both	<input type="checkbox"/>
Mon	1000	2400	State any proposed seasonal variations for the supply of alcohol (please read guidance note 9) New Years Eve/Day - we wish to extend the "finish" time to 0200 on New Year's Day.		
Tue	1000	2400			
Wed	1000	2400			
Thu	1000	2400	Non standard timings. Where you intend to use the premises for the supply of alcohol at different times to those listed in the column on the left, please list (please read guidance note 10)		
Fri	1000	0100	None		
Sat	1000	0100			
Sun	1000	2400			

M

Please highlight any adult entertainment or services, activities, other entertainment or matters ancillary to the use of the club premises that may give rise to concern in respect of children (please read guidance note 12)

None

N

Please identify any of the conditions, terms or restrictions currently imposed on the converted certificate which the club believes could be removed as a consequence of the proposed variation it is seeking

Existing clubhouse opening hours and liquor licensing hours.

O Please describe any additional steps that you intend to take in order to promote the four licensing objectives if the proposed variation is granted:

a) General – all four licensing objectives (b,c,d,e) (please read guidance note 13)

All Club staff are aware of and trained in the four licensing objectives detailed in boxes b), c), d), and e) below.
We have the pre-requisite dedicated Disabled car parking spaces adjacent to the clubhouse.

b) The prevention of crime and disorder

Club policy and staff training implemented to ensure that alcohol is not served to intoxicated or underage persons.
Regular liason with local police officer (PC Sarah Tate) and direct dial telephone contact.
The Club policy enforcing strict standards of dress and behaviour.
CCTV in main car park and Club Office.
Electronic access control system on all external Clubhouse doors.
Absolutely no discounted pricing or "happy hours" to encourage excessive drinking of alcohol.

c) Public safety

We have undertaken a fire and accident risk assessment of the premises and this is reviewed/updated on an annual basis (last review was 7th january 2005).
Illuminated emergency exit signs.
Regular staff training regarding fire evacuation procedures.
Fire evacuation drills undertaken every six months and recorded in fire log book.
Fire alarm and emergency lighting testing undertaken annually by qualified electrician and recorded in fire log book (copies of the current certificates are attached to this application).
The Club operates a self-imposed maximum occupancy limit of 130 instead of the potential premises maximum of 200.
Location and car park layout enables access for emergency vehicles at all times.
We have the requisite number of trained appointed persons to administer first-aid and use of First Responder emergency service, and all staff are aware of the location of the First Aid Box.

d) The prevention of public nuisance

All clubhouse entrances and exits are a minimum of 50 metres from the road, 100 metres from the nearest domestic dwellings and 150 metres from the nearest busness premises.
All clubhouse entrances and exits are on the side of the building furthest away from all of the above.
Signage in Clubhouse asks members and guests to leave the premises quietly.
We hold a maximum of 20 evening functions incorporating live or recorded music per year.

e) The protection of children from harm

The Club operates a formal written Junior Welfare Policy and we will immediately adopt the Golf Foundation's Children in Golf Welfare Policy as soon as it is published (expected June 2005). All staff instructed and trained in the principal issues of Children at risk outside the club, Children on their own at the club, children being supervised/escorted/transported by non-family adults, and children not being served or allowed to consume alcohol. We have a designated Junior Welfare Office/organiser on the Club Committee. Children are not allowed to use the low-jackpot gaming machine or cigarette vending machine.

Please tick Yes

- I have sent copies of this application to vary to responsible authorities and others where applicable
- I understand that I must now advertise my application to vary
- I understand that if I do not comply with the above requirements my application to vary will be rejected

Part B3 – Signatures (please read guidance note 4)

Signature for and on behalf of

Bramshaw Golf Club

[insert name of club]. (See guidance note 15)

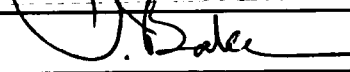
Signature	
Date	22/6/15
Capacity	General Manager

Contact name (where not previously given) and address for correspondence associated with this application (please read guidance note 16)

Ian Baker
Bramshaw Golf Club
Brook

Post town	Lyndhurst	Post code	SO43 7HE
------------------	-----------	------------------	----------

Notes for Guidance

PART A

1. Describe the premises. For example the type of premises, its general situation and layout and any other information which could be relevant to the licensing objectives. Where your application includes off-supplies of alcohol and you intend to provide place for consumption of these off-supplies you must include a description of where the place is and its proximity to the premises.
2. Where the conditions to which your existing certificate(s) is granted do not relate solely to any one of the four licensing objectives, please describe such conditions in the general box.

3. The law requires you to send a mandatory copy of this application to the chief officer of police for that area at the same time as sending to the local licensing authority.
4. The application form must be signed.
5. A club's agent (for example solicitor) may sign the form on its behalf provided that they have actual authority to do so.

PART B

This application cannot be used to vary the club premises certificate to vary substantially the premises to which it relates. If you wish to make that type of change to the club premises certificate you should make a new club premises certificate application under the Licensing Act 2003.

6. Please give timings in 24 hour clock.
7. Where taking place in a building or other structure, please tick as appropriate. Indoors may include a tent.
8. Please state type of activity to be authorised, if not already stated, and give relevant further details, for example (but not exclusively) whether or not music will be amplified or unamplified.
9. For example (but not exclusively), where the activity will occur on additional days during the summer months.
10. For example (but not exclusively), where you wish the activity to go on longer on a particular day e.g. Christmas Eve.
11. If you wish people to be able to consume alcohol on the premises please tick on, if you wish people to be able to purchase alcohol to consume away from the premises please tick off. If you wish people to be able to do both please tick both.
12. Please give information about anything to occur at the premises or ancillary to the use of the premises which may give rise to concern in respect of children, for example (but not exclusively) nudity or semi-nudity, films for restricted age groups, the presence of gambling machines.
13. Please list here steps you will take to promote all four licensing objectives together.
14. The application form must be signed.
15. A club's agent (for example solicitor) may sign the form on their behalf provided that they have actual authority to do so.
16. This is the address which we shall use to correspond with you about this application.

**IN THE COUNTY OF HAMPSHIRE
SOUTHAMPTON/NEW FOREST MAGISTRATES COURT**

Date of Meeting : 13th February 2003

Permit/Licence No : 1631

Original Grant :

Club Secretary :
R Tingey

Name & Address of Club :
BRAMSHAW GOLF CLUB
Club House
Brook
Lyndhurst
Hampshire

CLUB REGISTRATION CERTIFICATE

WHEREAS an application has been made for renewal of the registration certificate granted under Part II of the Licensing Act 1964 in respect of the above named club.

~~THIS IS TO CERTIFY~~ that the said certificate is renewed for a period of ~~FIVE~~ years from the date hereof and subject to the attached conditions (if any).

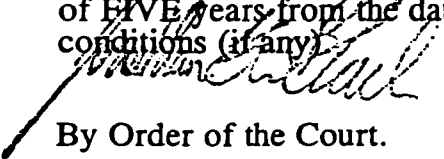
By Order of the Court.

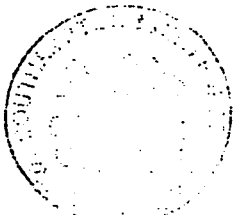

SOUTHAMPTON

Certified a true and complete
copy of the original

06 JUL 2005

NFDC Licensing Services

I hereby certify that this is a true copy of the original
Sol Proth-Eyre J.P. 10/06/05.

JOHN PROSTHWAITE-EYRE.

**BRAMSHAW GOLF CLUB :
FIRE PLAN - FLOOR LAYOUT ~**

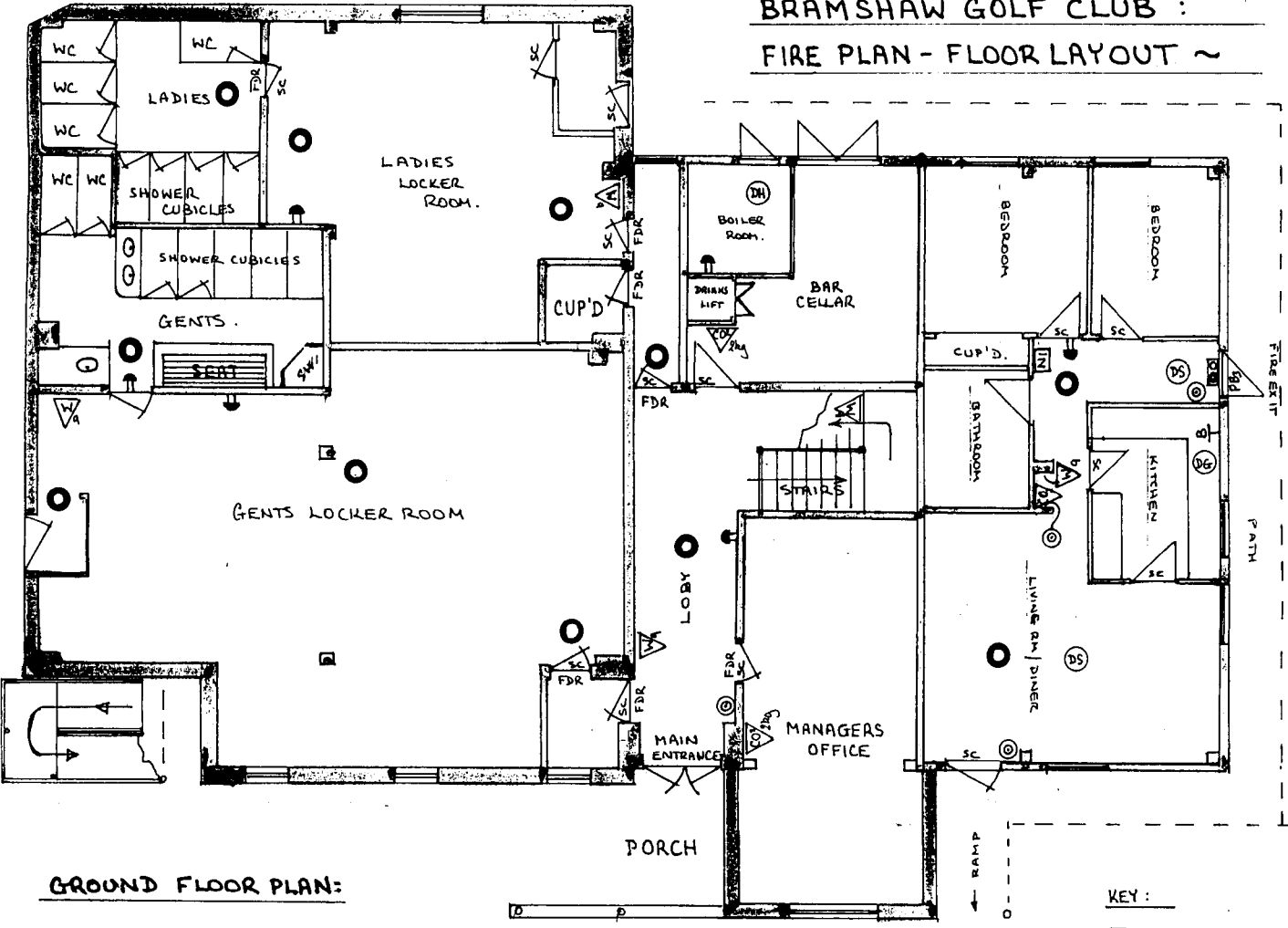

GROUND FLOOR PLAN:

'CLUB PREMISES CERTIFICATE APPLICATION' PLAN:

- KEY:**
- (GM) - GAMING MACHINE
 - (CH) - CIGARETTE MACHINE

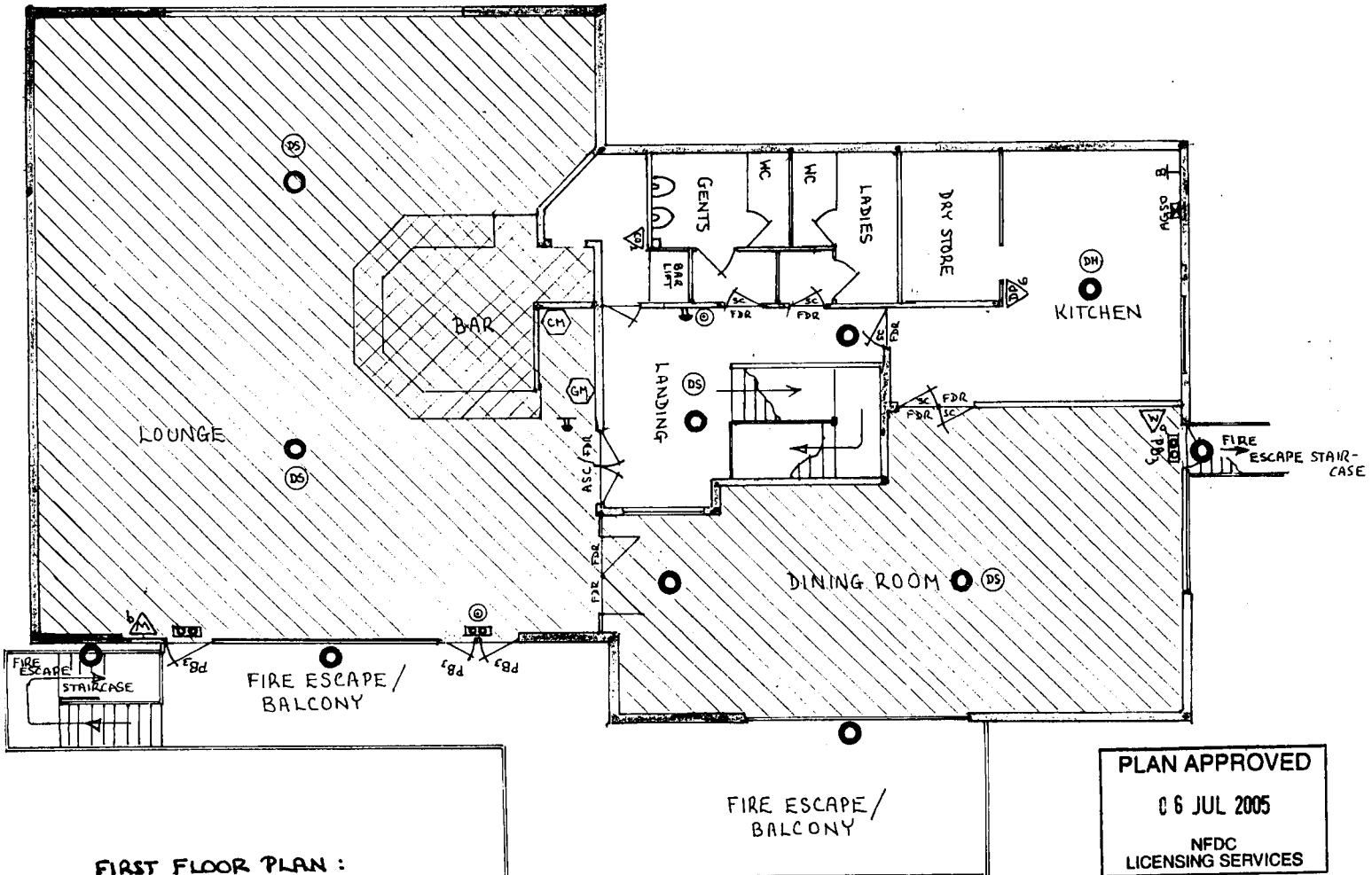

FIRST FLOOR PLAN :



















PLAN APPROVED
06 JUL 2005
NFDC
LICENSING SERVICES

1:100 SCALE

BROOK ENTERPRISES LTD

BRAMSHAW GOLF CLUB & ~~DUNWOOD MANOR GOLF CLUB~~

FIRE PLANS KEY LIST

DRY POWDER FIRE EXTINGUISHER	
WATER FIRE EXTINGUISHER	
CARBON DIOXIDE (CO²) FIRE EXTINGUISHER	
FOAM FIRE EXTINGUISHER	
FIRE BLANKET	
SMOKE DETECTOR	
HEAT DETECTOR	
CARBON MONOXIDE DETECTOR	
ILLUMINATED EMERGENCY EXIT LIGHT	
EMERGENCY LIGHT	
BREAK GLASS CALL POINT	
AUDIBLE WARNING DEVICE	
AUTOMATIC SELF CLOSING DOOR	ASC
DOOR SELF CLOSER	SC
1/2 HOUR FIRE CHECK DOOR	FDR
PUSH PAD/PUSH BAR	PB ₃
FIRE ALARM INDICATOR CONTROL PANEL	
NOTICE OF INSTRUCTION IN EVENT OF FIRE	
AUTOMATIC GAS SHUT OFF VALVE	
AREA OF LICENCED ACTIVITIES - Dunwood Manor Golf Club - Plays, Films, Indoor Sporting Events, Live Music, Recorded Music, Making Music, Dancing, Consumption of alcohol.	 N/A
AREA OF LICENCED ACTIVITIES - Supply of alcohol for consumption on the premises.	
AREA OF LICENCED ACTIVITIES - Bramshaw Golf Club - Films, Indoor Sporting Events, Live Music, Recorded Music, Making Music, Dancing, Consumption of alcohol.	

**GREENBANKS,
BROOK HILL,
BRAMSHAW,
LYNDHURST, SO43 7HD.**

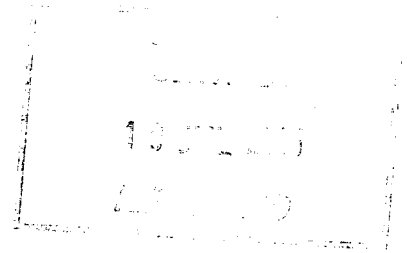

The Licensing Department,
The New Forest District Council,
Appletree Court,
Lyndhurst, SO43 7PA.

18th July 2005

Dear Sirs,

Ref: SW/PREM/CONV-VAR/07-2005/125Bramshaw Golf Club.

As a resident living close to the Bramshaw Golf Club I wish to record with you a number of objections to the above referenced application to convert their existing Club Registration Certificate and the variation of the their current Club Premises Certificate. Having requested and had a meeting with Mr I.Baker, the Manager of the Golf Club, I would state that I have no objections to the procedures, practices and business hours as operated under their present Club Licence and their Licence to sell alcohol as currently applied.

For the new application, referenced above, I wish to register my objection to the requested increase in hours available to sell alcohol. I also object to the extension of the number of activities and frequency of events, which are not necessarily linked to their core business of golf, which has been carried on since 1782. (ie. The oldest course in Hampshire).

My detailed objections are as follows:

PUBLIC NUISANCE

The increase in hours for entertainment and the sale of alcohol will almost certainly over time lead to a significant increase in the number of clientele arriving and departing by car/taxi. This will increase the amount of noise emanating from the cattle grid over which all vehicular traffic passes over on entering or leaving the premises. At night this additional traffic will also lead to an increase in light pollution caused by the headlights flashing on neighbouring properties during night hours. The entertainment/bar area is located on the first floor of the establishment and therefore the sound from this area carries a longer than normal distance. This is particularly true during the wintertime when there are no leaves on the trees.

PUBLIC SAFETY

The increase in traffic entering and leaving the premises, coupled with any traffic merging at the entrance from the jointly owned Bell Inn, will add an unacceptable increase in traffic at the already controversial junction of the B3078/3079. This will further increase the already established road safety hazard at this point and in particular at night and at peak traffic hours.

(n.b. this problem will be exacerbated by the increase in hours and activities currently applied for by the adjacent Green Dragon and forecast to be applied for by the Bell Inn. I also understand that the Sir Walter Tyrell Inn is applying for increased licence hours and for planning permission to erect additional bedrooms. The additional traffic anticipated from this establishment will also add to the hazard at this junction).

The, what is in effect, joint car parking facility at the site of the Golf Club and Bell Inn has on many occasions reached saturation with no overflow capability except for parking on the roadsides at the notorious junction. Thus creating an additional public safety hazard. (It should be noted that regular overflow parking from the Green Dragon Inn on the verges surrounding the junction contributes to the anticipated public safety issue).

CRIME & DISORDER

There have already been a number of reported incidents of theft from parked vehicles at the common parking area of the Golf Club and Bell Inn. Later opening hours and an increase in entertainment activities is likely to increase the number and spectrum of clientele attending the establishment which may increase the risk of crime in the area particularly with the closeness of the M27 as a 'get away' route. Also the adjacent open and forest areas constitute an escape route for potential perpetrators of crime.

PROTECTION OF CHILDREN

Later hours and the additional activities forecast are likely to increase the number of children attending the establishment.

All of the foregoing objections have an immediate impact upon the outside areas of the premises for the safety of children. It is assumed that the operational procedures cover the safety for children when inside the premises.

I, and other residents living close to the applicant have sought the views and support of our local Bramshaw Parish Council who will be expressing their position on this matter directly to you.

I look forward to your response on this matter,

Yours faithfully,

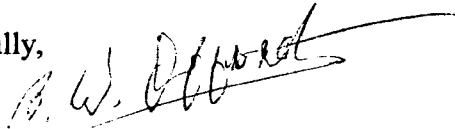

**ROOKS FARM,
BROOK,
LYNDHURST, SO43 7HD.**

The Licensing Department,
The New Forest District Council,
Appletree Court,
Lyndhurst, SO43 7PA.

18th July 2005

Dear Sirs,

Ref: SW/PREM/CONV-VAR/07-2005/125Bramshaw Golf Club.

As a resident living close to the Bramshaw Golf Club I wish to record with you a number of objections to the above referenced application to convert their existing Club Registration Certificate and the variation of the their current Club Premises Certificate. Having requested and had a meeting with Mr I.Baker, the Manager of the Golf Club, I would state that I have no objections to the procedures, practices and business hours as operated under their present Club Licence and their Licence to sell alcohol as currently applied.

For the new application, referenced above, I wish to register my objection to the requested increase in hours available to sell alcohol. I also object to the extension of the number of activities and frequency of events, which are not necessarily linked to their core business of golf, which has been carried on since 1782. (ie. The oldest course in Hampshire).

My detailed objections are as follows:

PUBLIC NUISANCE

The increase in hours for entertainment and the sale of alcohol will almost certainly over time lead to a significant increase in the number of clientele arriving and departing by car/taxi. This will increase the amount of noise emanating from the cattle grid over which all vehicular traffic passes over on entering or leaving the premises. At night this additional traffic will also lead to an increase in light pollution caused by the headlights flashing on neighbouring properties during night hours. The entertainment/bar area is located on the first floor of the establishment and therefore the sound from this area carries a longer than normal distance. This is particularly true during the wintertime when there are no leaves on the trees.

PUBLIC SAFETY

The increase in traffic entering and leaving the premises, coupled with any traffic merging at the entrance from the jointly owned Bell Inn, will add an unacceptable increase in traffic at the already controversial junction of the B3078/3079. This will further increase the already established road safety hazard at this point and in particular at night and at peak traffic hours.

(n.b. this problem will be exacerbated by the increase in hours and activities currently applied for by the adjacent Green Dragon and forecast to be applied for by the Bell Inn. I also understand that the Sir Walter Tyrell Inn is applying for increased licence hours and for planning permission to erect additional bedrooms. The additional traffic anticipated from this establishment will also add to the hazard at this junction).

The, what is in effect, joint car parking facility at the site of the Golf Club and Bell Inn has on many occasions reached saturation with no overflow capability except for parking on the roadsides at the notorious junction. Thus creating an additional public safety hazard. (It should be noted that regular overflow parking from the Green Dragon Inn on the verges surrounding the junction contributes to the anticipated public safety issue).

CRIME & DISORDER

There have already been a number of reported incidents of theft from parked vehicles at the common parking area of the Golf Club and Bell Inn. Later opening hours and an increase in entertainment activities is likely to increase the number and spectrum of clientele attending the establishment which may increase the risk of crime in the area particularly with the closeness of the M27 as a 'get away' route. Also the adjacent open and forest areas constitute an escape route for potential perpetrators of crime.

PROTECTION OF CHILDREN

Later hours and the additional activities forecast are likely to increase the number of children attending the establishment.

All of the foregoing objections have an immediate impact upon the outside areas of the premises for the safety of children. It is assumed that the operational procedures cover the safety for children when inside the premises.

I, and other residents living close to the applicant have sought the views and support of our local Bramshaw Parish Council who will be expressing their position on this matter directly to you.

I look forward to your response on this matter,

Yours faithfully,

A. C. Howie for self and Angela K
Howie

**BROOK BUSHES,
BROOK HILL,
BRAMSHAW,
LYNDHURST, SO43 7JB.**

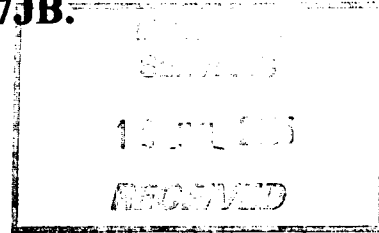

The Licensing Department,
The New Forest District Council,
Appletree Court,
Lyndhurst, SO43 7PA.

18th July 2005

Dear Sirs,

Ref: SW/PREM/CONV-VAR/07-2005/125Bramshaw Golf Club.

As a resident living close to the Bramshaw Golf Club I wish to record with you a number of objections to the above referenced application to convert their existing Club Registration Certificate and the variation of the their current Club Premises Certificate. Having requested and had a meeting with Mr I.Baker, the Manager of the Golf Club, I would state that I have no objections to the procedures, practices and business hours as operated under their present Club Licence and their Licence to sell alcohol as currently applied.

For the new application, referenced above, I wish to register my objection to the requested increase in hours available to sell alcohol. I also object to the extension of the number of activities and frequency of events, which are not necessarily linked to their core business of golf, which has been carried on since 1782. (ie. The oldest course in Hampshire).

My detailed objections are as follows:

PUBLIC NUISANCE

The increase in hours for entertainment and the sale of alcohol will almost certainly over time lead to a significant increase in the number of clientele arriving and departing by car/taxi. This will increase the amount of noise emanating from the cattle grid over which all vehicular traffic passes over on entering or leaving the premises. At night this additional traffic will also lead to an increase in light pollution caused by the headlights flashing on neighbouring properties during night hours. The entertainment/bar area is located on the first floor of the establishment and therefore the sound from this area carries a longer than normal distance. This is particularly true during the wintertime when there are no leaves on the trees.

PUBLIC SAFETY

The increase in traffic entering and leaving the premises, coupled with any traffic merging at the entrance from the jointly owned Bell Inn, will add an unacceptable increase in traffic at the already controversial junction of the B3078/3079. This will further increase the already established road safety hazard at this point and in particular at night and at peak traffic hours.

(n.b. this problem will be exacerbated by the increase in hours and activities currently applied for by the adjacent Green Dragon and forecast to be applied for by the Bell Inn. I also understand that the Sir Walter Tyrell Inn is applying for increased licence hours and for planning permission to erect additional bedrooms. The additional traffic anticipated from this establishment will also add to the hazard at this junction).

The, what is in effect, joint car parking facility at the site of the Golf Club and Bell Inn has on many occasions reached saturation with no overflow capability except for parking on the roadsides at the notorious junction. Thus creating an additional public safety hazard. (It should be noted that regular overflow parking from the Green Dragon Inn on the verges surrounding the junction contributes to the anticipated public safety issue).

CRIME & DISORDER

There have already been a number of reported incidents of theft from parked vehicles at the common parking area of the Golf Club and Bell Inn. Later opening hours and an increase in entertainment activities is likely to increase the number and spectrum of clientele attending the establishment which may increase the risk of crime in the area particularly with the closeness of the M27 as a 'get away' route. Also the adjacent open and forest areas constitute an escape route for potential perpetrators of crime.

PROTECTION OF CHILDREN

Later hours and the additional activities forecast are likely to increase the number of children attending the establishment.

All of the foregoing objections have an immediate impact upon the outside areas of the premises for the safety of children. It is assumed that the operational procedures cover the safety for children when inside the premises.

I, and other residents living close to the applicant have sought the views and support of our local Bramshaw Parish Council who will be expressing their position on this matter directly to you.

I look forward to your response on this matter,

Yours faithfully,



Peter N. Reynolds

**OAK TREE COTTAGE,
BROOK,
BRAMSHAW,
LYNDHURST, SO43 7HD.**

The Licensing Department,
The New Forest District Council,
Appletree Court,
Lyndhurst, SO43 7PA.

18th July 2005

Dear Sirs,

Ref: SW/PREM/CONV-VAR/07-2005/125Bramshaw Golf Club.

As a resident living close to the Bramshaw Golf Club I wish to record with you a number of objections to the above referenced application to convert their existing Club Registration Certificate and the variation of the their current Club Premises Certificate. Having requested and had a meeting with Mr I.Baker, the Manager of the Golf Club, I would state that I have no objections to the procedures, practices and business hours as operated under their present Club Licence and their Licence to sell alcohol as currently applied.

For the new application, referenced above, I wish to register my objection to the requested increase in hours available to sell alcohol. I also object to the extension of the number of activities and frequency of events, which are not necessarily linked to their core business of golf, which has been carried on since 1782. (ie. The oldest course in Hampshire).

My detailed objections are as follows:

PUBLIC NUISANCE

The increase in hours for entertainment and the sale of alcohol will almost certainly over time lead to a significant increase in the number of clientele arriving and departing by car/taxi. This will increase the amount of noise emanating from the cattle grid over which all vehicular traffic passes over on entering or leaving the premises. At night this additional traffic will also lead to an increase in light pollution caused by the headlights flashing on neighbouring properties during night hours. The entertainment/bar area is located on the first floor of the establishment and therefore the sound from this area carries a longer than normal distance. This is particularly true during the wintertime when there are no leaves on the trees.

PUBLIC SAFETY

The increase in traffic entering and leaving the premises, coupled with any traffic merging at the entrance from the jointly owned Bell Inn, will add an unacceptable increase in traffic at the already controversial junction of the B3078/3079. This will further increase the already established road safety hazard at this point and in particular at night and at peak traffic hours.

(n.b. this problem will be exacerbated by the increase in hours and activities currently applied for by the adjacent Green Dragon and forecast to be applied for by the Bell Inn. I also understand that the Sir Walter Tyrell Inn is applying for increased licence hours and for planning permission to erect additional bedrooms. The additional traffic anticipated from this establishment will also add to the hazard at this junction).

The, what is in effect, joint car parking facility at the site of the Golf Club and Bell Inn has on many occasions reached saturation with no overflow capability except for parking on the roadsides at the notorious junction. Thus creating an additional public safety hazard. (It should be noted that regular overflow parking from the Green Dragon Inn on the verges surrounding the junction contributes to the anticipated public safety issue).

CRIME & DISORDER

There have already been a number of reported incidents of theft from parked vehicles at the common parking area of the Golf Club and Bell Inn. Later opening hours and an increase in entertainment activities is likely to increase the number and spectrum of clientele attending the establishment which may increase the risk of crime in the area particularly with the closeness of the M27 as a 'get away' route. Also the adjacent open and forest areas constitute an escape route for potential perpetrators of crime.

PROTECTION OF CHILDREN

Later hours and the additional activities forecast are likely to increase the number of children attending the establishment.

All of the foregoing objections have an immediate impact upon the outside areas of the premises for the safety of children. It is assumed that the operational procedures cover the safety for children when inside the premises.

I, and other residents living close to the applicant have sought the views and support of our local Bramshaw Parish Council who will be expressing their position on this matter directly to you.

I look forward to your response on this matter,

Yours faithfully,



R. G. BLACKHAM

**Fountain Court
Bramshaw
Lyndhurst
Hants, SO437JB**
Tel; (44) 23 8081 4104
Fax; (44) 23 8081 3667
david@lockuk.com

18 July 2005.

The Licensing Department,
The New Forest District Council,
Appletree Court,
Lyndhurst, SO43 7PA.

Dear Sirs,

Ref: SW/PREM/CONV-VAR/07-2005/125Bramshaw Golf Club.

As a resident living close to the Bramshaw Golf Club I wish to record with you a number of objections to the above referenced application to convert their existing Club Registration Certificate and the variation of the their current Club Premises Certificate. Having requested and had a meeting with Mr I. Baker, the Manager of the Golf Club, I would state that I have no objections to the procedures, practices and business hours as operated under their present Club Licence and their Licence to sell alcohol as currently applied.

For the new application, referenced above, I wish to register my objection to the requested increase in hours available to sell alcohol. I also object to the extension of the number of activities and frequency of events, which are not necessarily linked to their core business of golf, which has been carried on since 1782. (ie. The oldest course in Hampshire).

My detailed objections are as follows:

PUBLIC NUISANCE

The increase in hours for entertainment and the sale of alcohol will almost certainly over time lead to a significant increase in the number of clientele arriving and departing by car/taxi. This will increase the amount of noise emanating from the cattle grid over which all vehicular traffic passes over on entering or leaving the premises. At night this additional traffic will also lead to an increase in light pollution caused by the headlights flashing on neighbouring properties during night hours. The entertainment/bar area is located on the first floor of the establishment and therefore the sound from this area carries a longer than normal distance. This is particularly true during the wintertime when there are no leaves on the trees.

PUBLIC SAFETY

The increase in traffic entering and leaving the premises, coupled with any traffic merging at the entrance from the jointly owned Bell Inn, will add an unacceptable increase in traffic at the already controversial junction of the B3078/3079. This will further increase the already established road safety hazard at this point and in particular at night and at peak traffic hours.

(n.b. this problem will be exacerbated by the increase in hours and activities currently applied for by the adjacent Green Dragon and forecast to be applied for by the Bell Inn. I also understand that the Sir Walter Tyrell Inn is applying for increased licence hours and for planning permission to erect additional bedrooms. The additional traffic anticipated from this establishment will also add to the hazard at this junction).

The, what is in effect, joint car parking facility at the site of the Golf Club and Bell Inn has on many occasions reached saturation with no overflow capability except for parking on the roadsides at the notorious junction. Thus creating an additional public safety hazard. (It should be noted that regular overflow parking from the Green Dragon Inn on the verges surrounding the junction contributes to the anticipated public safety issue).

CRIME & DISORDER

There have already been a number of reported incidents of theft from parked vehicles at the common parking area of the Golf Club and Bell Inn. Later opening hours and an increase in entertainment activities is likely to increase the number and spectrum of clientele attending the establishment which may increase the risk of crime in the area particularly with the closeness of the M27 as a 'get away' route. Also the adjacent open and forest areas constitute an escape route for potential perpetrators of crime.

PROTECTION OF CHILDREN

Later hours and the additional activities forecast are likely to increase the number of children attending the establishment.

All of the foregoing objections have an immediate impact upon the outside areas of the premises for the safety of children. It is assumed that the operational procedures cover the safety for children when inside the premises.

I, and other residents living close to the applicant have sought the views and support of our local Bramshaw Parish Council who will be expressing their position on this matter directly to you. I am a member of the Bramshaw Golf Club.

I look forward to your response on this matter,

Yours faithfully,

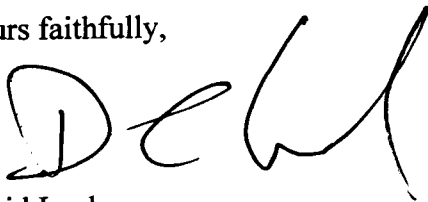

David Lock

V

**DEERFOLD,
BROOK HILL,
BRAMSHAW,
LYNDHURST, SO43 7JB**

The Licensing Department,
The New Forest District Council,
Appletree Court,
Lyndhurst, SO43 7PA.

18th July 2005

Dear Sirs,

Ref: SW/PREM/CONV-VAR/07-2005/125Bramshaw Golf Club.

As a resident living close to the Bramshaw Golf Club I wish to record with you a number of objections to the above referenced application to convert their existing Club Registration Certificate and the variation of their current Club Premises Certificate. Having requested and had a meeting with Mr I. Baker, the Manager of the Golf Club, I would state that I have no objections to the procedures, practices and business hours as operated under their present Club Licence and their Licence to sell alcohol as currently applied.

For the new application, referenced above, I wish to register my objection to the requested increase in hours available to sell alcohol. I also object to the extension of the number of activities and frequency of events, which are not necessarily linked to their core business of golf, which has been carried on since 1782. (ie. The oldest course in Hampshire).

My detailed objections are as follows:

PUBLIC NUISANCE

The increase in hours for entertainment and the sale of alcohol will almost certainly over time lead to a significant increase in the number of clientele arriving and departing by car/taxi. This will increase the amount of noise emanating from the cattle grid over which all vehicular traffic passes over on entering or leaving the premises. At night this additional traffic will also lead to an increase in light pollution caused by the headlights flashing on neighbouring properties during night hours. The entertainment/bar area is located on the first floor of the establishment and therefore the sound from this area carries a longer than normal distance. This is particularly true during the wintertime when there are no leaves on the trees.

PUBLIC SAFETY

The increase in traffic entering and leaving the premises, coupled with any traffic merging at the entrance from the jointly owned Bell Inn, will add an unacceptable increase in traffic at the already controversial junction of the B3078/3079. This will further increase the already established road safety hazard at this point and in particular at night and at peak traffic hours.

(n.b. this problem will be exacerbated by the increase in hours and activities currently applied for by the adjacent Green Dragon and forecast to be applied for by the Bell Inn. I also understand that the Sir Walter Tyrell Inn is applying for increased licence hours and for planning permission to erect additional bedrooms. The additional traffic anticipated from this establishment will also add to the hazard at this junction).

The, what is in effect, joint car parking facility at the site of the Golf Club and Bell Inn has on many occasions reached saturation with no overflow capability except for parking on the roadsides at the notorious junction. Thus creating an additional public safety hazard. (It should be noted that regular overflow parking from the Green Dragon Inn on the verges surrounding the junction contributes to the anticipated public safety issue).

CRIME & DISORDER

There have already been a number of reported incidents of theft from parked vehicles at the common parking area of the Golf Club and Bell Inn. Later opening hours and an increase in entertainment activities is likely to increase the number and spectrum of clientele attending the establishment which may increase the risk of crime in the area particularly with the closeness of the M27 as a 'get away' route. Also the adjacent open and forest areas constitute an escape route for potential perpetrators of crime.

PROTECTION OF CHILDREN

Later hours and the additional activities forecast are likely to increase the number of children attending the establishment.

All of the foregoing objections have an immediate impact upon the outside areas of the premises for the safety of children. It is assumed that the operational procedures cover the safety for children when inside the premises.

I, and other residents living close to the applicant have sought the views and support of our local Bramshaw Parish Council who will be expressing their position on this matter directly to you.

I look forward to your response on this matter,

Yours faithfully,



**YOUNGS ORCHARD,
BRAMSHAW,
LYNDHURST, SO43 7JB**

The Licensing Department,
The New Forest District Council,
Appletree Court,
Lyndhurst, SO43 7PA.

18th July 2005

Dear Sirs,

Ref: SW/PREM/CONV-VAR/07-2005/125Bramshaw Golf Club.

As a resident living close to the Bramshaw Golf Club I wish to record with you a number of objections to the above referenced application to convert their existing Club Registration Certificate and the variation of the their current Club Premises Certificate. Having requested and had a meeting with Mr I.Baker, the Manager of the Golf Club, I would state that I have no objections to the procedures, practices and business hours as operated under their present Club Licence and their Licence to sell alcohol as currently applied.

For the new application, referenced above, I wish to register my objection to the requested increase in hours available to sell alcohol. I also object to the extension of the number of activities and frequency of events, which are not necessarily linked to their core business of golf, which has been carried on since 1782. (ie. The oldest course in Hampshire).

My detailed objections are as follows:

PUBLIC NUISANCE

The increase in hours for entertainment and the sale of alcohol will almost certainly over time lead to a significant increase in the number of clientele arriving and departing by car/taxi. This will increase the amount of noise emanating from the cattle grid over which all vehicular traffic passes over on entering or leaving the premises. At night this additional traffic will also lead to an increase in light pollution caused by the headlights flashing on neighbouring properties during night hours. The entertainment/bar area is located on the first floor of the establishment and therefore the sound from this area carries a longer than normal distance. This is particularly true during the wintertime when there are no leaves on the trees.

PUBLIC SAFETY

The increase in traffic entering and leaving the premises, coupled with any traffic merging at the entrance from the jointly owned Bell Inn, will add an unacceptable increase in traffic at the already controversial junction of the B3078/3079. This will further increase the already established road safety hazard at this point and in particular at night and at peak traffic hours.

(n.b. this problem will be exacerbated by the increase in hours and activities currently applied for by the adjacent Green Dragon and forecast to be applied for by the Bell Inn. I also understand that the Sir Walter Tyrell Inn is applying for increased licence hours and for planning permission to erect additional bedrooms. The additional traffic anticipated from this establishment will also add to the hazard at this junction).

The, what is in effect, joint car parking facility at the site of the Golf Club and Bell Inn has on many occasions reached saturation with no overflow capability except for parking on the roadsides at the notorious junction. Thus creating an additional public safety hazard. (It should be noted that regular overflow parking from the Green Dragon Inn on the verges surrounding the junction contributes to the anticipated public safety issue).

CRIME & DISORDER

There have already been a number of reported incidents of theft from parked vehicles at the common parking area of the Golf Club and Bell Inn. Later opening hours and an increase in entertainment activities is likely to increase the number and spectrum of clientele attending the establishment which may increase the risk of crime in the area particularly with the closeness of the M27 as a 'get away' route. Also the adjacent open and forest areas constitute an escape route for potential perpetrators of crime.

PROTECTION OF CHILDREN

Later hours and the additional activities forecast are likely to increase the number of children attending the establishment.

All of the foregoing objections have an immediate impact upon the outside areas of the premises for the safety of children. It is assumed that the operational procedures cover the safety for children when inside the premises.

I, and other residents living close to the applicant have sought the views and support of our local Bramshaw Parish Council who will be expressing their position on this matter directly to you.

I look forward to your response on this matter,

Yours faithfully,



L. B. MEYNELL

18TH. JULY 2005.

Canterton lodge,
Brook,
Lyndhurst,
Hants.
SO43 7HE.

The Licensing Department,
The New Forest District Council,
Appletree Court,
Lyndhurst , SO43 7PA

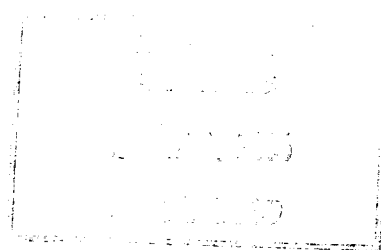

Dear Sirs,

Ref: SW/PREM/CONV-VAR/07-2005/125 Bramshaw Golf Club.

My wife and I are close residents of the Bramshaw Golf Club and I wish to record objections to the proposed application to cover the existing Club Registration Certificate and the variation of the Club Premises Certificate of the Bramshaw Golf Club.

I have no objection to the licences currently in effect.

On the proposed new application I wish to register my objection to their requested increase in hours available to sell alcohol and to the extension to the number of activities and frequency of events which would not necessarily be confined to their core business of golf.

My objections are as follows:

PUBLIC NUISANCE;

The increase in hours of entertainment and the sale of alcohol will undoubtedly lead to an increase in the number of persons arriving and departing by car or taxi. This will increase the amount of late night/early morning noise arising from the cattle grid over which all vehicles pass. There will be an increase in light pollution with vehicle headlights shining on windows of premises close to the road. The entertainment/bar area of the golf club is on the first floor and thus noise will carry further late at night.

PUBLIC SAFETY:

The increase of traffic entering and leaving the premises, using the same access as the Bell Hotel will add an unacceptable amount of traffic at the junction of thge B3078 and B3079. This could lead to a safety risk at this junction . The car park of the golf club , which also serves the Bell Inn is, on occasions, filled to overflowing. Cars are parked on the verges alongside the adjacent roads.

CRIME AND DISORDER:

With an extension of licensing hours there is a strong likelihood of an increase in the number of vehicles being left overnight in the Bramshaw Golf Club/ Bell Inn car park. I understand there have already been a number of reported thefts from vehicles in this car park.

GENERAL:

The area is one of low background noise. As such vehicle noise and the noise of people enjoying themselves can be heard clearly. This is entirely reasonable provided that the hours to which such noise extends, is limited. Any extension beyond the

current 11pm closing time is , but for celebrations such as New Year, unacceptable and the granting of a licence with such extensive scope would be to disregard the needs and rights of the rate payers living in the area.

Yours Faithfully,

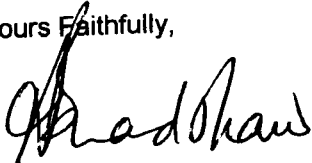

A.E. BRADSHAW

7

**WALDRONS,
BROOK,
LYNDHURST, SO43 7H**

The Licensing Department,
The New Forest District Council,
Appletree Court,
Lyndhurst, SO43 7PA.

18th July 2005

Dear Sirs,

Ref: SW/PREM/CONV-VAR/07-2005/125Bramshaw Golf Club.

As a resident living close to the Bramshaw Golf Club I wish to record with you a number of objections to the above referenced application to convert their existing Club Registration Certificate and the variation of the their current Club Premises Certificate. Having requested and had a meeting with Mr I.Baker, the Manager of the Golf Club, I would state that I have no objections to the procedures, practices and business hours as operated under their present Club Licence and their Licence to sell alcohol as currently applied.

For the new application, referenced above, I wish to register my objection to the requested increase in hours available to sell alcohol. I also object to the extension of the number of activities and frequency of events, which are not necessarily linked to their core business of golf, which has been carried on since 1782. (ie. The oldest course in Hampshire).

My detailed objections are as follows:

PUBLIC NUISANCE

The increase in hours for entertainment and the sale of alcohol will almost certainly over time lead to a significant increase in the number of clientele arriving and departing by car/taxi. This will increase the amount of noise emanating from the cattle grid over which all vehicular traffic passes over on entering or leaving the premises. At night this additional traffic will also lead to an increase in light pollution caused by the headlights flashing on neighbouring properties during night hours. The entertainment/bar area is located on the first floor of the establishment and therefore the sound from this area carries a longer than normal distance. This is particularly true during the wintertime when there are no leaves on the trees.

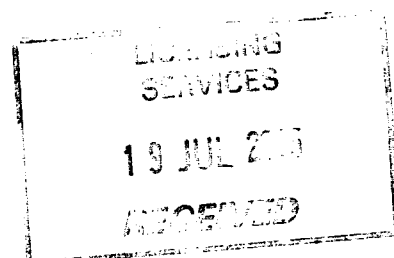

PUBLIC SAFETY

The increase in traffic entering and leaving the premises, coupled with any traffic merging at the entrance from the jointly owned Bell Inn, will add an unacceptable increase in traffic at the already controversial junction of the B3078/3079. This will further increase the already established road safety hazard at this point and in particular at night and at peak traffic hours.

(n.b. this problem will be exacerbated by the increase in hours and activities currently applied for by the adjacent Green Dragon and forecast to be applied for by the Bell Inn. I also understand that the Sir Walter Tyrell Inn is applying for increased licence hours and for planning permission to erect additional bedrooms. The additional traffic anticipated from this establishment will also add to the hazard at this junction).

The, what is in effect, joint car parking facility at the site of the Golf Club and Bell Inn has on many occasions reached saturation with no overflow capability except for parking on the roadsides at the notorious junction. Thus creating an additional public safety hazard. (It should be noted that regular overflow parking from the Green Dragon Inn on the verges surrounding the junction contributes to the anticipated public safety issue).

CRIME & DISORDER

There have already been a number of reported incidents of theft from parked vehicles at the common parking area of the Golf Club and Bell Inn. Later opening hours and an increase in entertainment activities is likely to increase the number and spectrum of clientele attending the establishment which may increase the risk of crime in the area particularly with the closeness of the M27 as a 'get away' route. Also the adjacent open and forest areas constitute an escape route for potential perpetrators of crime.

PROTECTION OF CHILDREN

Later hours and the additional activities forecast are likely to increase the number of children attending the establishment.

All of the foregoing objections have an immediate impact upon the outside areas of the premises for the safety of children. It is assumed that the operational procedures cover the safety for children when inside the premises.

I, and other residents living close to the applicant have sought the views and support of our local Bramshaw Parish Council who will be expressing their position on this matter directly to you.

I look forward to your response on this matter,

Yours faithfully,

J. J. Robinson (Mrs)

J. J. ROBINSON